

Fitting Guide

BEHIND-THE-EAR HEARING INSTRUMENTS

Super Power BTE



Fitting Guide

Super Power BTE Hearing Systems

Table of Contents

Hearing Instrument Overview	5
Fitting Range	5
Installation of Right/Left Indicators	6
Attaching and Removing the Earhook	6
Changing the Damper in the Earhook	7
Replacing the Battery Door	7
DAI/FM Shoe	9
Attaching the DAI/FM Shoe	9
Using the FM Shoe	9
Using the DAI Shoe	10
Fitting a Super Power BTE with Oasis	11
Attaching the Programming Cables	11
Ordering Information	12

Hearing Instrument Overview

Super Power BTE hearing aids are made for clients with severe to profound hearing loss. This guide is designed to help you fit and manage Super Power BTE hearing systems.

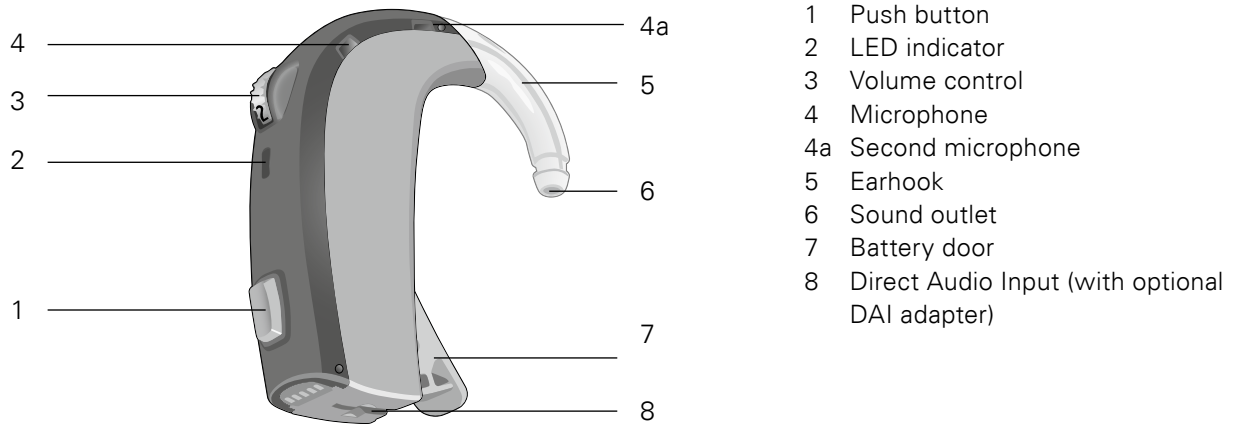

Fitting Range

The expected fitting range of the Super Power hearing aid is shown below.

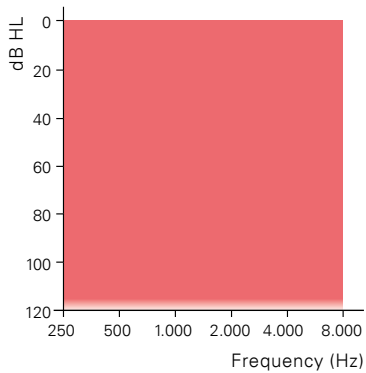

Installation of Right/Left Indicators

- 1 Open the battery door
- 2 Insert the marker end into the slot as shown
- 3 Twist and rotate the stick to break off the marker
- 4 Close the battery door

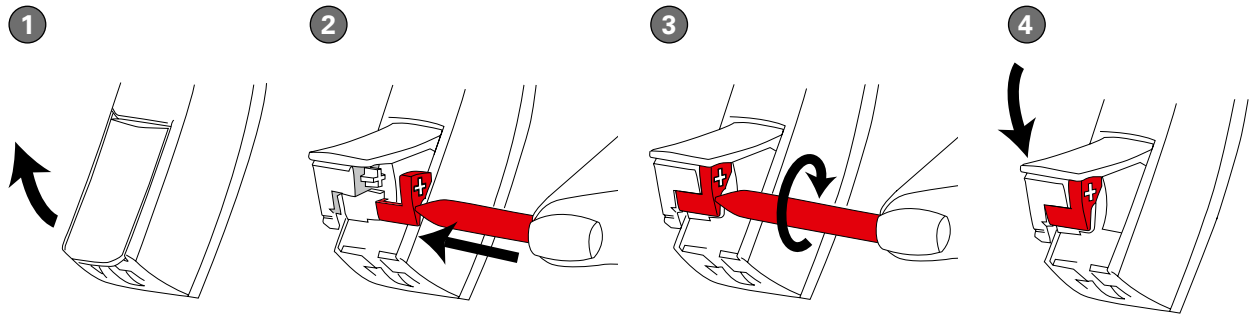

Attaching and Removing the Earhook

The Super Power hearing aid is available with either the conventional earhook used for adults or the child earhook used for pediatrics. The changing mechanism is the same for both earhooks.

- 1 Use the pointed end of the disassembly tool to push the lock pin free
- 2 Replace the earhook
- 3 Replace the lock pin (tweezers make this easier)

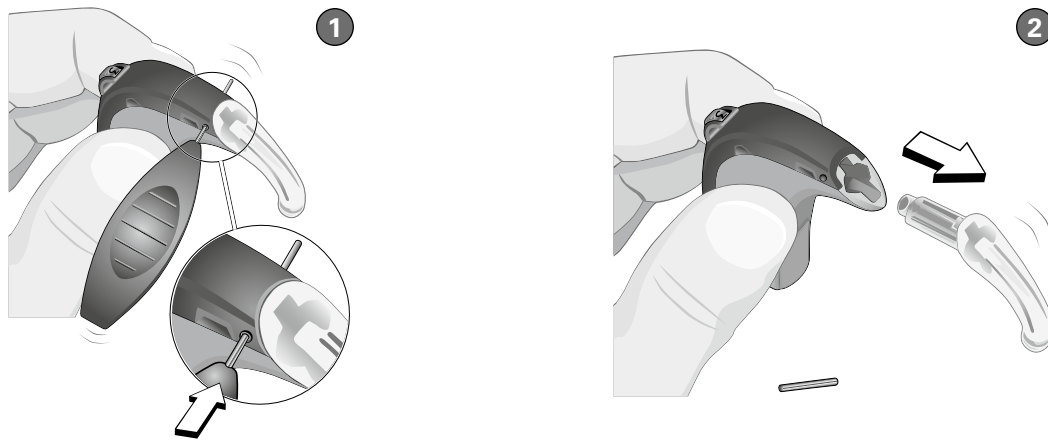

Changing the Damper in the Earhook

- 1 Take a new damper from the turtle
- 2 Insert the empty end of the tool into the earhook's existing damper and pull it out
- 3 Insert the new damper into the earhook
- 4 Discard the used tool

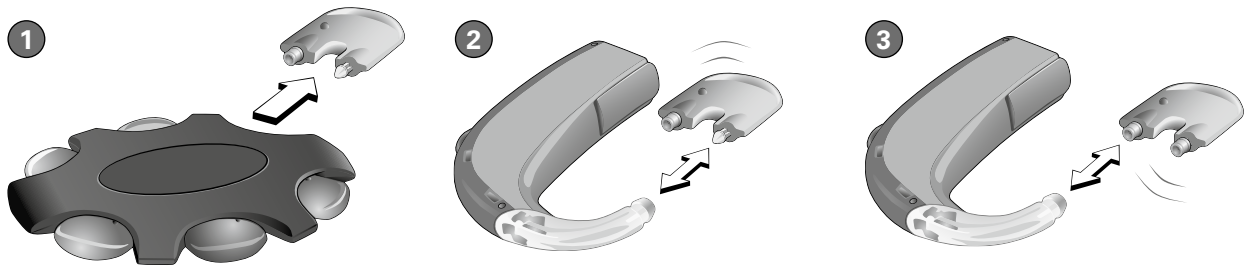

Replacing the Battery Door

- 1 Open the battery door and place the battery removal tool as shown
- 2 Gently pull the battery door off
- 3 Snap the new battery door in place and close

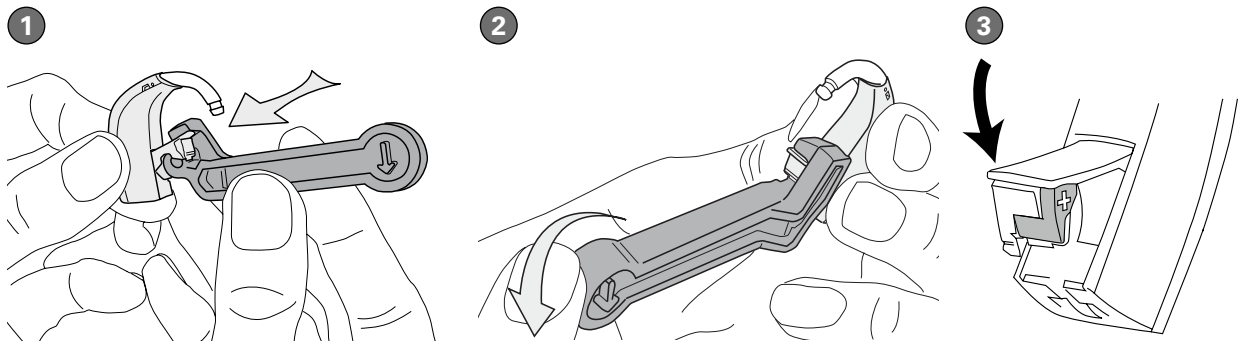

Tamper-Resistant Battery Door

The Super Power BTE has an optional tamper-resistant battery door that can be ordered separately. A tamper-resistant door should be used for small children and vulnerable persons.

To lock the door, close the battery door completely. Use a small screwdriver to turn the lock so that the line is horizontal. To unlock, turn the lock so that the line is vertical.

Insert a small screwdriver into the slit in the bottom of the instrument and push to open.

Locked

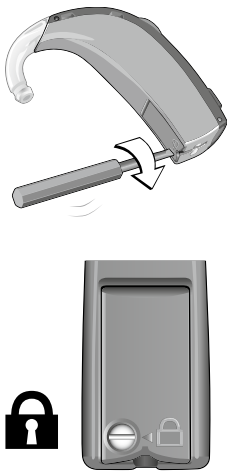

Unlocked

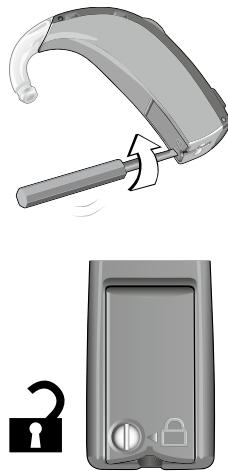

Open Tamper-Resistant Battery Door

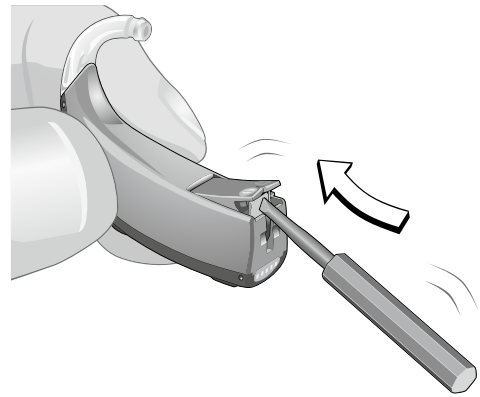

DAI/FM Shoe

Attaching the DAI/FM Shoe

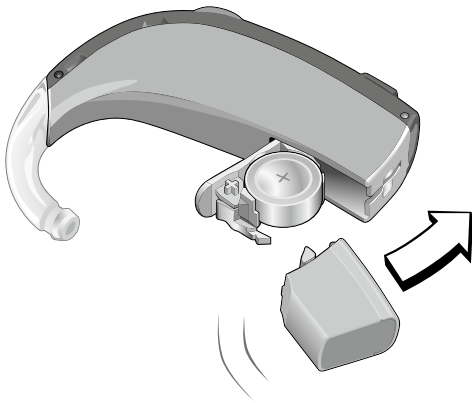

- 1 Open the battery door fully
- 2 Slide the DAI/FM shoe into the slot until it lines up with the hearing aid
- 3 Close the battery door again and connect the desired accessory

Using the FM Shoe

The Super Power hearing aid is compatible with all commonly available ear level FM systems (FM receivers). The connection is established via the Europlug.

Chose the FM shoe also when attaching a CROS microphone unit to the hearing aid.

Using the DAI Shoe

Direct Audio Input (DAI) enables the hearing aid to receive signals directly from external sources such as a TV, personal stereo, PC audio output, MP3 player, etc.

The DAI shoe offers a Europlug connection to establish a wired coupling via the DAI cord to an external source.

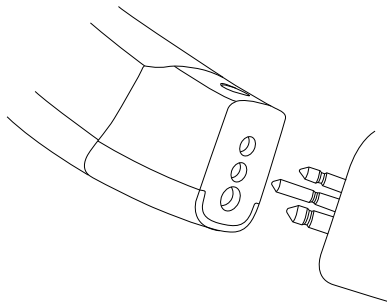

The DAI shoe comes with two adjustable trimmers.

Use the trimmer on the front to adjust the individual volume.

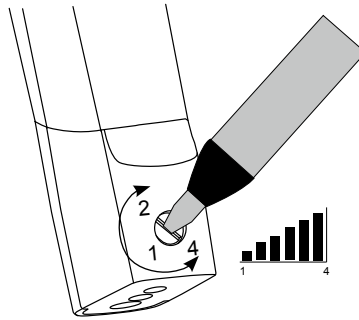

The trimmer on the top selects the input impedance.

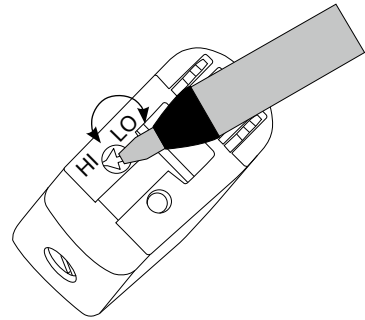

Position HI: TV, stereo, MP3 player, PC, etc.

Position LO: Bodyworn FM solutions

Fitting a Super Power BTE with Oasis

Super Power hearing systems are programmed with Oasis using new standard (no. 2) programming cables.

Please always insert a fresh battery prior to programming.

For your convenience, wireless Super Power hearing aids are compatible with the FittingLINK and nEARcom wireless programming systems.

Attaching the Programming Cables

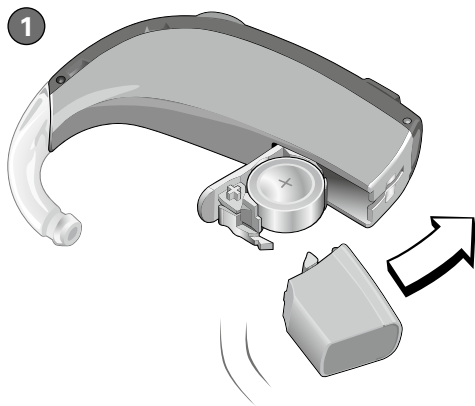

- 1 Open the battery door fully and slide the programming adapter into the slot until it lines up with the hearing aid

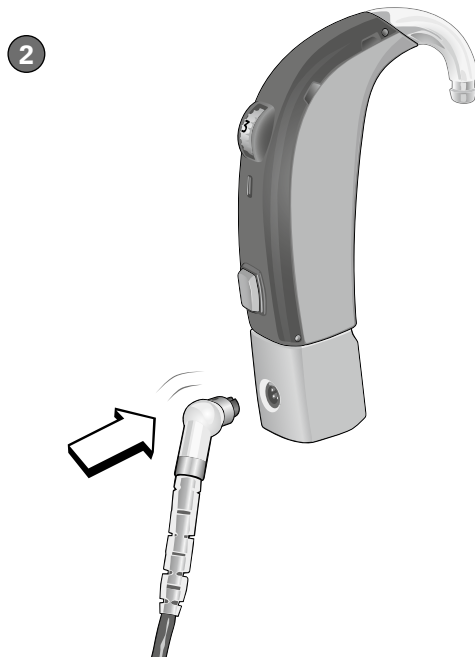

- 2 Close the battery door again and plug in the cable as shown

Ordering Information

I. Wired Accessories

Part Number	Designation	Comments
147602	DAI Adapter	Product of SBO
147435	FM Adapter	Product of SBO
153877	CROS microphone unit	Product of SBO

2. Programming Equipment

2.1 Cables

Part Number	Designation	Comments
384-20-033-00	Prog. cable, Nr. 2 New standard (HiPro) Blue, left	
384-20-032-00	Prog. cable, Nr. 2 New standard (HiPro) Red, right	
384-20-035-00	Prog. cable, Nr. 2 New standard (NOAHlink) Blue, left	
384-20-034-00	Prog. cable, Nr. 2 New standard (NOAHlink) Red, right	

2.2 Adapter

Part Number	Designation	Comments
399-50-640-00	Programming adapter	Suitable for SP, Micro and Compact Power BTEs CP/CPx

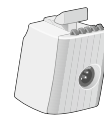

2.3 Programming Interface

Part Number	Designation	Comments
144720	FittingLINK	Wireless programming interface. Product of SBO.



3. Spare Parts

3.1 Hooks

Part Number	Designation	Comments
571-01-140-00	Adult earhook	
106141	Adult earhook damped	
689-30-320-00	Damping elements	Turtle with 6 dampers

3.2 Right/Left Indicators

Part Number	Designation	Comments
101217	Color plug set right/left	1 red and 1 blue

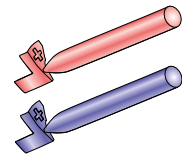

3.3 Tools

Part Number	Designation	Comments
101484	Battery door removal tool set	
890-22-270-00	Disassembly tool for lock pin	

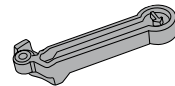

4. Pediatric Items

4.1 Tools

Part Number	Designation	Comments
145601	TAR battery drawer SR3	
144307	TAR battery drawer SR7	
571-01-110-00	Child earhook	
106168	Child earhook damped	
152883	YoungStar kit	YoungStar kit contains: <ul style="list-style-type: none"> • Bag with optional shoulder strap • Cleaning and drying set • Cleaning cloth • Listening tube • Battery tester • Otoclip • Lion hand puppet • Pediatric Instrument Care Guide

Since 1946, we have been passionate about developing quality hearing systems that enable people with hearing difficulties to enjoy authentic listening experiences. With Swiss Engineering, precision technology, and our commitment to individual service, we strive to exceed our customer's expectations. Our aim is to provide extra value to our partners every day. Bernafon representatives and employees in over 70 countries fulfill our vision to help people with impaired hearing communicate again without limitation.

Manufacturer:
Bernafon AG
Morgenstrasse 131
3018 Bern
Switzerland
www.bernafon.com

**Local Manufacturer
& Distributor:**
Bernafon Canada
500 Trillium Drive, Unit 15
Kitchener, ON, N2R 1A7
www.bernafon.ca

SWISS 
Engineering

Bernafon Companies

Australia · Canada · China · Denmark · Finland · France · Germany · Italy · Japan · Korea · Netherlands · New Zealand · Poland · Spain · Sweden · Switzerland · Turkey · UK · USA

www.bernafon.com

bernafon 
Your hearing • Our passion